

LCPVEK SOLENOID OPERATED ISOLATION VALVES

edwardsvacuum.com

Edwards' aluminium LCPVEK valves are designed for vacuum applications which need a compact, simple, solenoid operation valve to control gas flow.

These economical valves are ideal for a number of duties ranging from simple laboratory pump isolation to OEM vacuum system integration and design. Their versatility makes them effective both in vacuum pipelines and in chamber admittance applications.

Careful design of the solenoid power control and vacuum isolation components delivers efficient magnetic actuation with optimum vacuum performance at an affordable price.

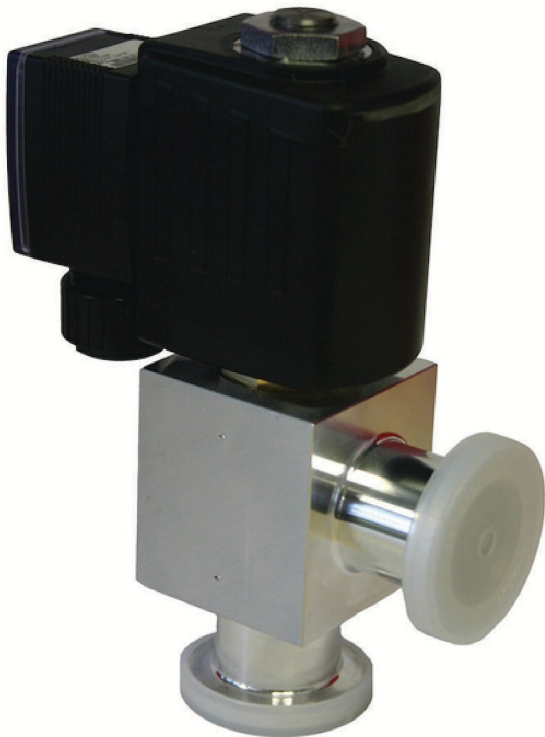

FEATURES AND BENEFITS

- Economical design
- Electrical actuation
- Low power requirements
- Electronic boost power supply
- Efficient magnetic design

TECHNICAL DATA

LCPVEK		
Valve actuation type	Single acting, electrically opened, spring return	
Molecular conductance	1.5 ls ⁻¹	
Pressure range	mbar (Torr)	1 x 10 ⁻⁶ - 1000 (7.5 x 10 ⁻⁷ - 750)
Max pressure differential (open/close)	mbar (Torr)	1000 (750)
Time to open	ms	20
Time to close	ms	50
Max cycle frequency	h ⁻¹	600
Leak rate	mbar	Typically 1 x 10 ⁻⁶ ls ⁻¹
	Torr	Typically 7.5 x 10 ⁻⁷ ls ⁻¹
Power consumption		
Open	72 W for 400 ms / 50-110 ms (a.c./d.c. supply)	
Hold	5 W a.c./d.c.	
Operating temperature range	-10 to 55 °C	
Weight		
LCPV16EK	g (oz)	900 (31)
LCPV25EK	g (oz)	900 (31)
Enclosure rating	IP65	
Voltage		
24V a.c./d.c.	+/- 10%	
230 V	+/- 10%	
110 V	+/- 10%	
Construction materials		
Body	Aluminium, stainless steel, silver	
Seals	FKM Fluoroelastomer	

ORDERING INFORMATION

Description	Order No.
LCPV16EKA 24 V a.c./d.c. solenoid Valve	C41780200
LCPV25EKA 24V a.c./d.c. solenoid valve	C41790200
LCPV16EKA 110V a.c. solenoid valve	C41780100
LCPV25EKA 110V a.c. solenoid valve	C41790100
LCPV16EKA 230V a.c. solenoid valve	C41780000
LCPV25EKA 230V a.c. solenoid valve	C41790000

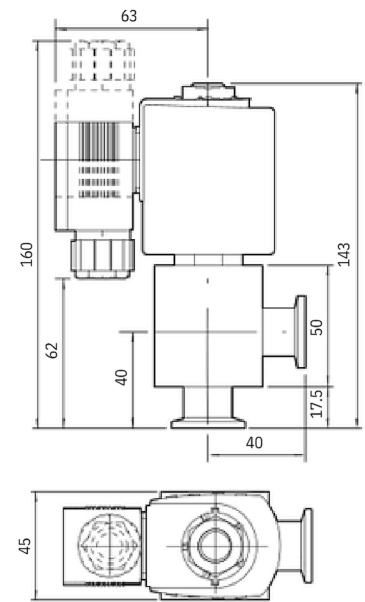

NW16

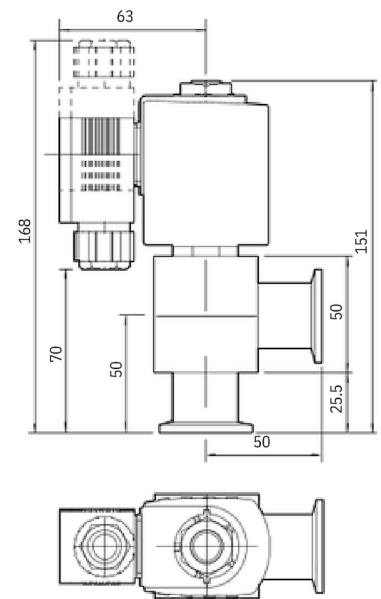

NW25

Publication Number: 3601 0824 01
 © Edwards Limited 2024. All rights reserved.
 Edwards and the Edwards logo are trademarks of Edwards Limited.

Whilst we make every effort to ensure that we accurately describe our products and services, we give no guarantee as to the accuracy or completeness of any information provided in this datasheet.

Edwards Ltd, registered in England and Wales
 No. 6124750, registered office: Innovation Drive,
 Burgess Hill, West Sussex, RH15 9TW, UK.

